

Appendix 2: Maps detailing the development of the Infirmary

- 1 Radcliffe Infirmary Building – Built in 1770
- 2 Original Laundry 1770 – Later converted to Hakewill Fever Block
- 3 Radcliffe Observatory 1795
- 4 Laundry & Coal Store
- 5 Accident Ward 1858
- 6 Outpatients Hall, Laboratory & Mortuary 1863
- 7 St Luke's Chapel 1863
- 8 Fever Block 1870 – Converted to Women's Block in 1876
- 9 St Paul's Church 1836
- 10 St Paul's School
- 11 New Laundry 1876
- 12 Children's Block 1877
- 13 Fever Block 1877 – Later converted to the Oxford Eye Hospital
- 14 Outpatients Building 1913
- 15 Nurses Accommodation 1922
- 16 The 'Hut' – temporary accommodation, later converted to X-Ray Department
- 17 Operating Theatre 1899
- 18 Marlborough and Rowney Wards 1894
- 19 Heliometer Rotunda, 1849-1875
- 20 Nurses Home & Kitchens 1932
- 21 Operating Theatres 1932
- 22 Cronshaw Ward 1932
- 23 Children's Block 1936
- 24 Symonds & Morris Block 1932
- 25 Nurses Lecture Theatre 1938
- 26 Private Block 1934
- 27 Maternity Home 1931, extended in 1939
- 28 EMS Huts 1940, improved 1955
- 29 Pathology Department 1945, later the Gibson Building 1964
- 30 Anaesthetics, Surgery & Canteen 1967
- 31 Dispensary 1968
- 32 WHTS Lecture Theatre
- 33 Harkness Building 1970
- 34 Tower Block 1971

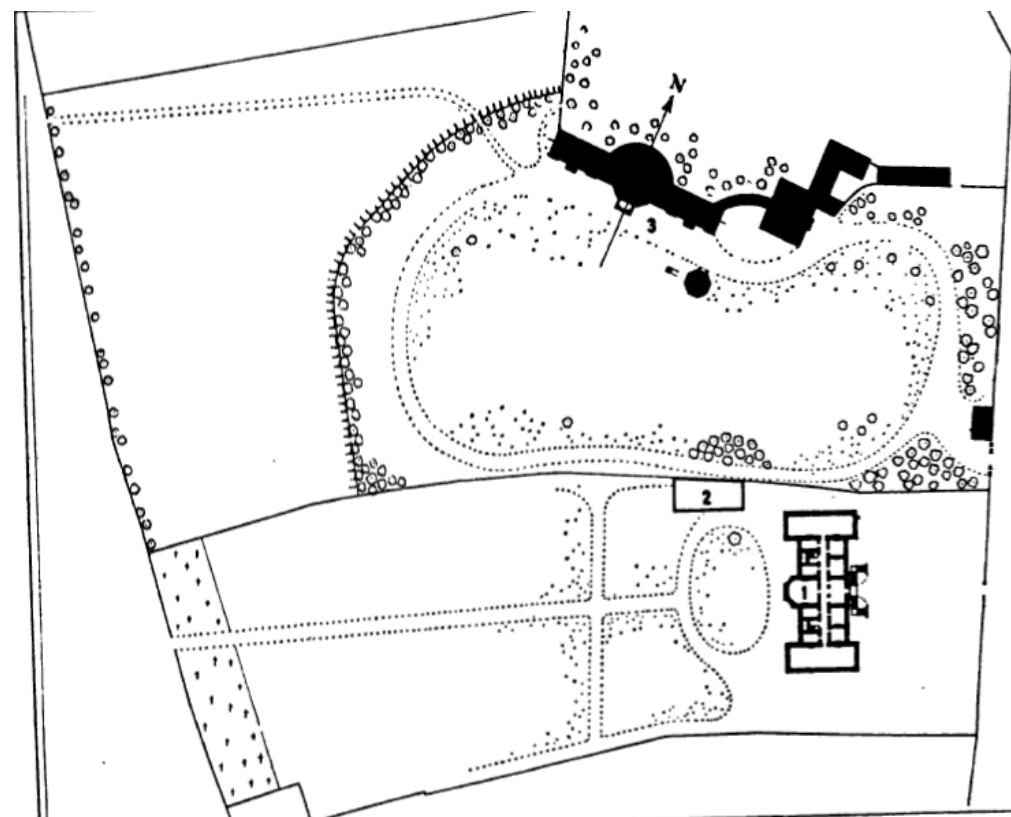

1775

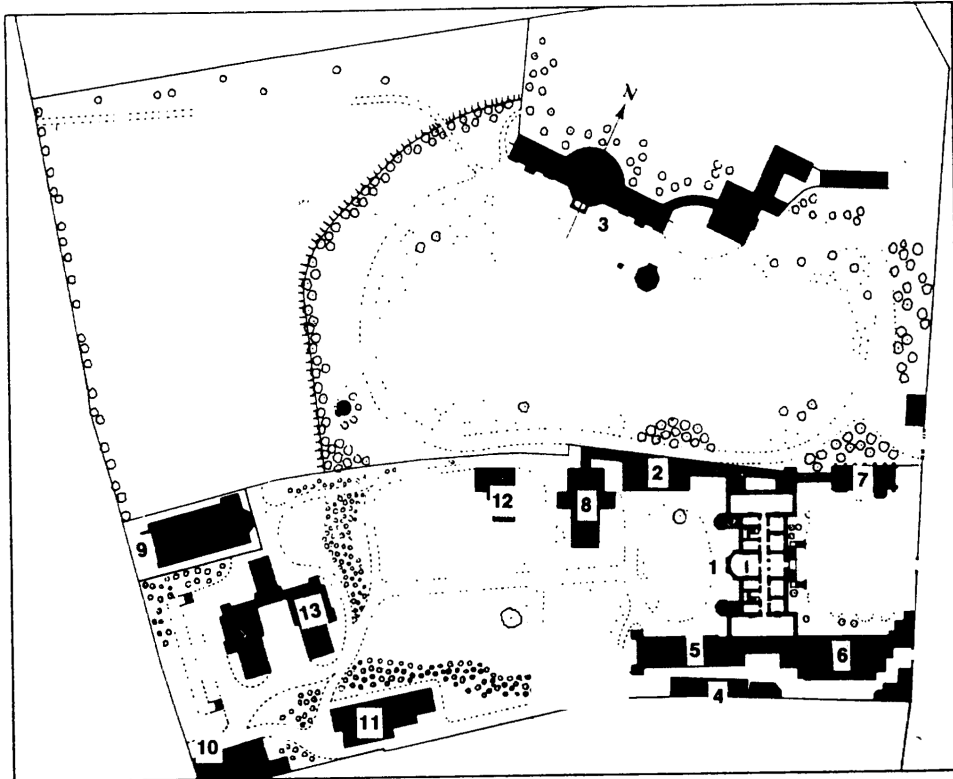

1875

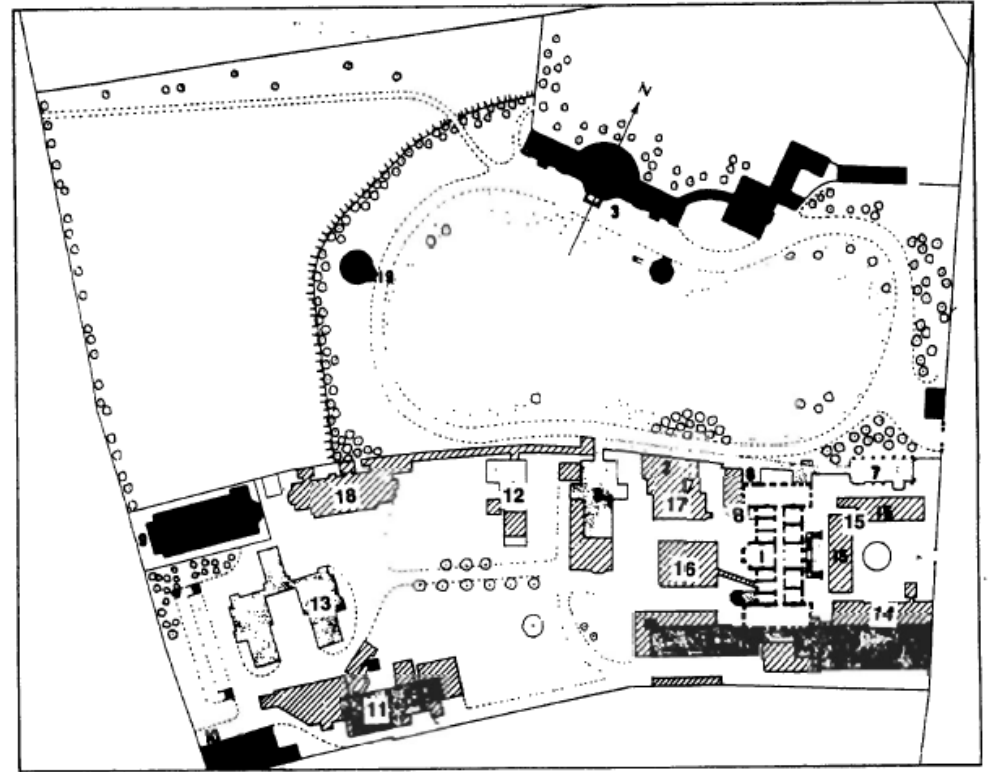

1924

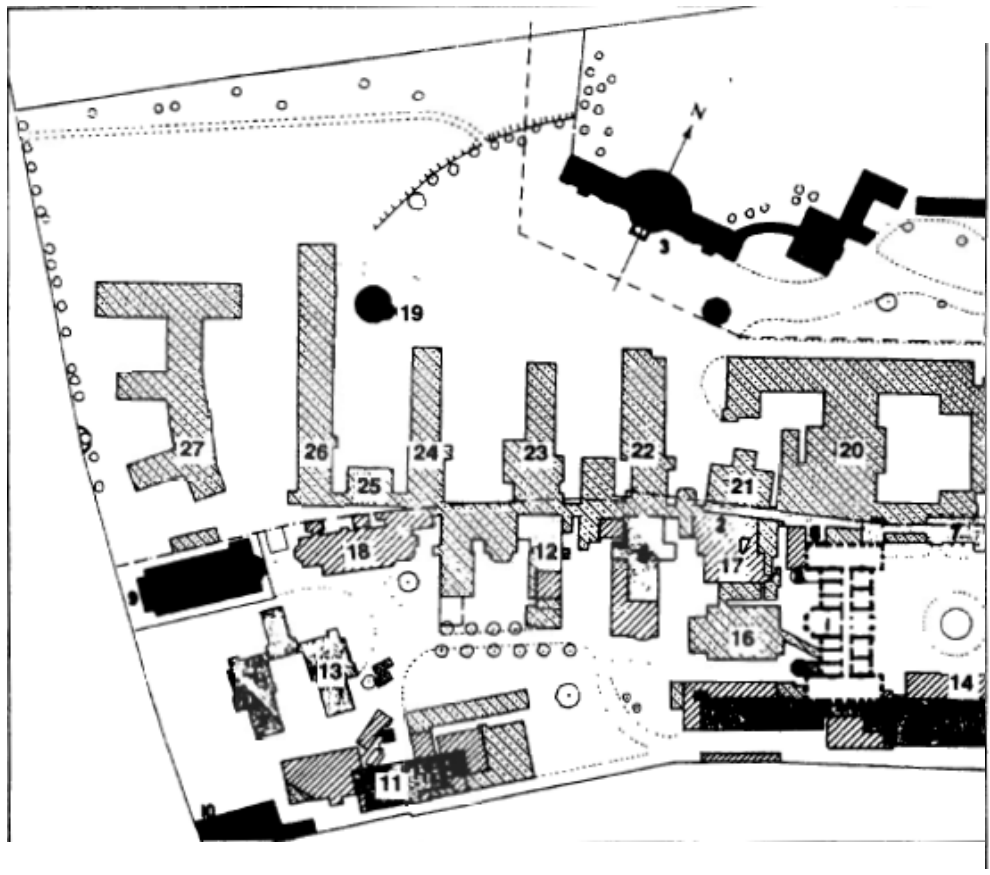

1939

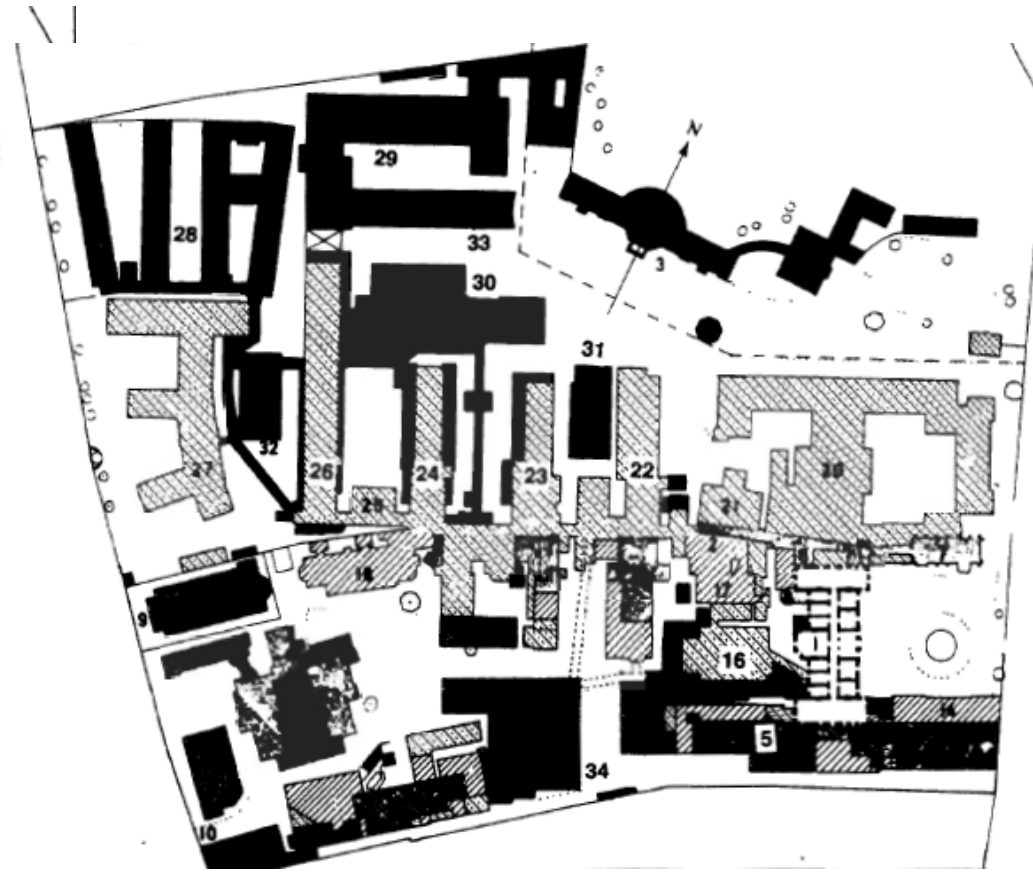

1970